



## Pressure regulators 40bar - G<sup>1</sup>/<sub>4</sub> – G<sup>1</sup>/<sub>2</sub>

Pressure regulators regulate the system pressure ( $p_1$ ) in a compressed air system to the working pressure ( $p_2$ ) and keep this pressure, regardless of pressure fluctuations and air consumption, largely constant.

Pressure regulator (diaphragm type) with servomechanism. Port sizes G<sup>1</sup>/<sub>4</sub> to G<sup>1</sup>/<sub>2</sub>. The excess pressure valve (secondary venting) allows a reduction of the secondary pressure ( $p_2$ ) (= exhaust) without air extraction. Working pressure ranges from 0,5 to 3, 6, 10, 16 and 25 bar. Adjustment by means of a locknut. Gauge can be mounted on either side. Panel or bracket mounting if desired. **Note:** To avoid losses an air filter should be installed upstream. **Also suitable for use with neutral and non-toxic gases!**

### Standard versions:

#### Control range 0,5 - 10bar, with gauge

Size	Order No.	
	Connection threads G <sup>1</sup> / <sub>4</sub>	G <sup>1</sup> / <sub>2</sub>
small	<b>286.323</b>	-
medium	-	<b>274.663</b>

### Order key for all variants:

286/274.xxx

- |  |                           |
|--|---------------------------|
| 1 – 0,5- 3bar                                  | } control range ( $p_2$ ) |
| 2 – 0,5- 6bar                                  |                           |
| 3 – 0,5- 10bar                                 |                           |
| 4 – 0,5- 16bar                                 |                           |
| 5 – 0,5- 25bar (not size small)                |                           |
| 2 – G <sup>1</sup> / <sub>4</sub>              | } connection threads      |
| 6 – G <sup>1</sup> / <sub>2</sub>              |                           |
| 3 – with gauge (size small, except for 25 bar) |                           |
| 6 – with gauge (size medium)                   |                           |
| 4 – without gauge                              |                           |

for example:

274.663 – **without gauge** and  
**0,5 - 16bar** = 274.464

### Spare parts and accessories

**Bracket mounting** for fixing on lid

**Panel mounting**

Panel thread M14x1 (size small), M22x1 (size medium)

**Gauge** horizontal,

ø40 (size small)

ø63 (size medium)

Display range: 0 - 6bar (for  $p_2$  up to 3 bar)

0 - 10bar (for  $p_2$  up to 6 bar)

0 - 16bar (for  $p_2$  up to 10 bar)

0 - 25bar (for  $p_2$  up to 16 bar)

0 - 40bar (for  $p_2$  up to 25 bar)

**Seal cone** complete

**Diaphragm** complete

Control range (for  $p_2$ ): 0 - 3bar

0 - 10bar

0 - 16bar

0 - 25bar

Order No.	
small	medium
<b>286-88</b>	<b>274-48</b>
<b>286-89</b>	<b>274-49</b>
<b>714</b>	<b>213</b>
<b>723</b>	<b>214</b>
<b>734</b>	<b>215</b>
<b>745</b>	<b>216</b>
-	<b>217</b>
<b>286-120</b>	<b>274-75</b>
<b>286-126</b>	<b>274-65</b>
<b>286-126</b>	<b>274-66</b>
<b>286-126</b>	<b>274-67</b>
-	<b>274-67</b>

Gauges see chapter 11

### Technical data

	Size small	Size medium
<b>Nominal rates of flow*</b>	430NI/min	1250NI/min
<b>Max. operating pressure (<math>p_1</math>)</b>	40bar (PN40)	40bar (PN40)
<b>Control range for secondary pressure (<math>p_2</math>)</b>	0,5 up to 3, 6, 10, 16, 25bar	0,5 up to 3, 6, 10, 16, 25bar
<b>Operating temperature</b>	-10°C up to +90°C	-10°C up to +90°C
<b>Control range (<math>p_2</math>)</b>	0,5 to 3, 6, 10, 16 and 25bar	0,5 bis 3, 6, 10, 16 und 25bar
<b>Mounting position</b>	any	any
<b>Direction of flow</b>	see arrow	see arrow
<b>Nominal width</b>	DN6	DN12
<b>Dependence upon supply pressure</b>	< 10 %	< 4 %
<b>Reversing control hysteresis</b>	~ 1 bar	~ 1 bar
<b>Weight</b>	390g	1000g
<b>Material</b>	- diaphragm/seals - housing/spring cover	NBR brass

\* measured at  $p_1 = 8\text{bar}$ ,  $p_2 = 6\text{bar}$  and  $\Delta p = 1\text{bar}$

### Rates of flow $p_1 = p_2 + 2\text{bar}$

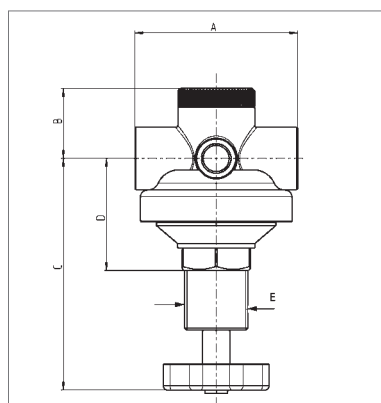
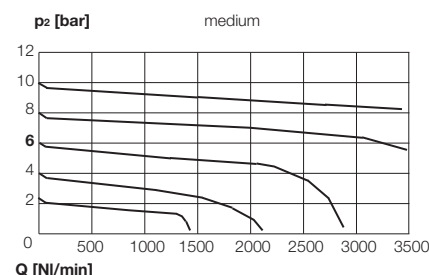
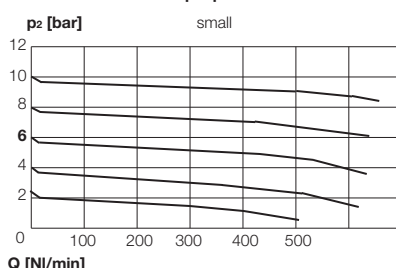

### Dimensions [mm]

Size	small	medium
<b>Connection threads</b>	G <sup>1</sup> / <sub>4</sub>	G <sup>1</sup> / <sub>2</sub>
<b>A</b>	45	72
<b>B</b>	23	30
<b>C</b>	81	115
<b>D</b>	35	52
<b>E</b>	M20x1,5	M28x1,5

Fasteners and connecting elements see page 49